



# WAITARA

7/36-40 Romsey Street

## Ground Floor Apartment with Elevated Terrace

 2  2  1

In an ultra-convenient location, this modern two-bedroom apartment is an excellent location. Featuring generous, contemporary light filled interiors, the property also boasts an oversized wrap around terrace ideal for entertaining. Situated only moments' walk to Waitara train station, Hornsby Girls High School and Waitara Primary School, Hornsby Westfield and train station as well as Willow Park, everything you need is on your doorstep.

- Spacious open plan living/dining with tiled flooring
- Granite gas kitchen, SMEG and Miele appliances
- Tiled throughout, carpet bedrooms
- Mirrored BIR's to both bedrooms
- Ensuite to master and modern main bath
- Gas heating outlets, split system air conditioning
- Tiled entertainers terrace and internal laundry
- Single secure parking spot plus lift entry from basement
- Gas usage included

For further information please contact Saliba Estate Agents 02 4504 8004.

We have obtained all information in this document from sources we believe to be reliable, however, we cannot guarantee its accuracy. Prospective tenants are advised to carry out their own investigations.

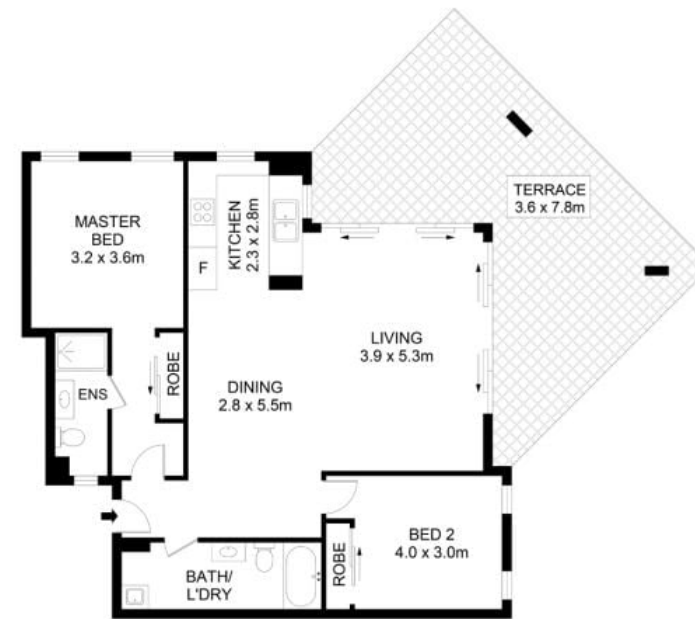

7/36-40 Romsey St, Waitara

Disclaimer- Floor Plan measurements are approximate and are for illustrative purposes only. While we cannot doubt the floor plans accuracy, we make no guarantee, warranty or representation as to the accuracy and completeness of the floor plan.



INTERNAL AREA > 78 SQM  
EXTERNAL AREA > 49 SQM  
TOTAL AREA > 127 SQM

Saliba Estate Agents 0450 178 002 Paul Maatouk 0405 572 665

**SALIBA** Estate Agents